

TURN-KEY PACKAGE

\$519,000 | Size of Home 198m²

Lot 704 Potters Lane Raymond Terrace 630m²



Photo indicative only

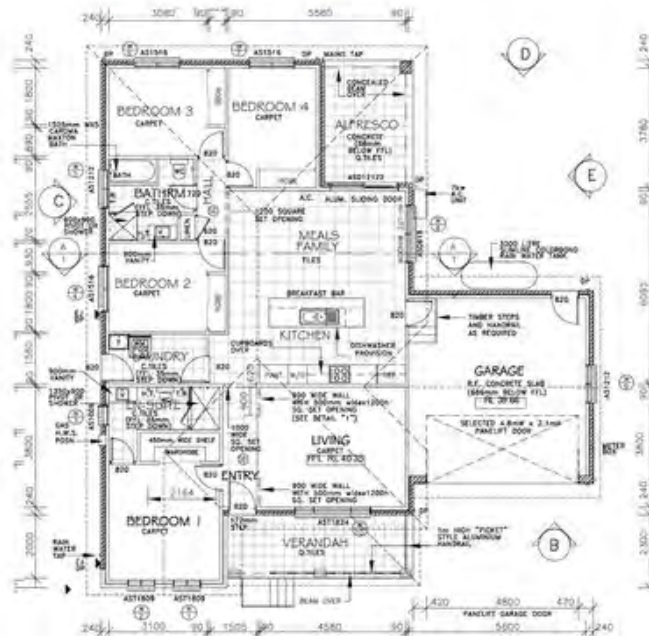

TURN-KEY INCLUSIONS

- All Council requirements
- Stone Kitchen Benchtop
- Stainless Steel Kitchen 900mm Appliances
- Blinds
- Carpet and Tiles
- Downlights
- Ceiling Fans
- Ducted Air Conditioning
- Covered Alfresco
- Fully fenced, turfed and landscaped
- Clothesline and Letterbox
- Termite Protection
- Driveway

The house will be completely finished inside and out.

Carnelian
PROJECTS

HELPING YOU BUILD YOUR NEW HOME

FOR FURTHER INFORMATION CALL

Kerri-Ann | 0402 107 194